

SK2010-095 1 A

REVISIONS			
REV	DESCRIPTION	DATE	BY
A	REDESIGNED DOORS	14 APR 11	R.F.T.

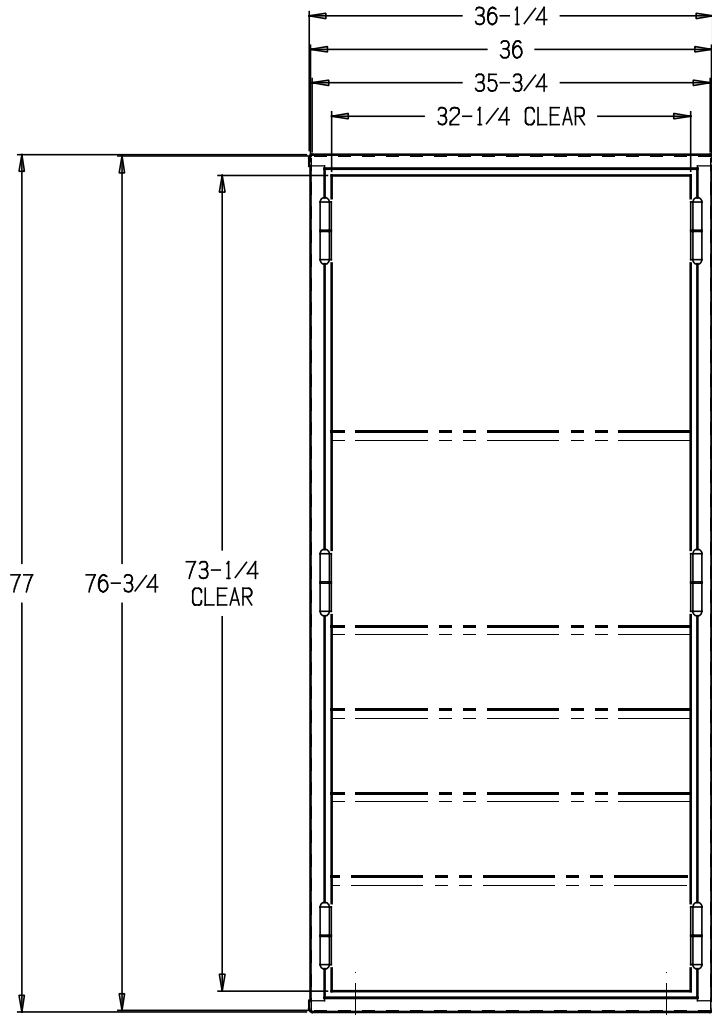

FRONT VIEW
(SHOWN WITHOUT DOORS)

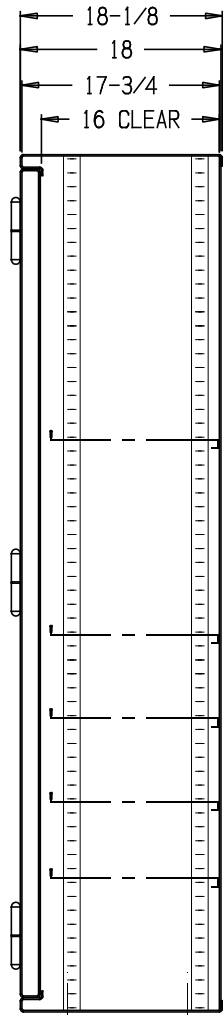

SECTION VIEW

CUSTOMER SIGNATURE		AMSEC AMERICAN SECURITY PRODUCTS COMPANY		
CUSTOMER NAME		B Form DD - 77.00 x 36.00 x 18.00 O.D. with MEDECO		
DATE		ML #	B □ # 041742-3	SK2010-095
COMPANY NAME		PROPRIETARY INFORMATION UNAUTHORIZED RELEASE WITHOUT EXPRESS WRITTEN PERMISSION OF AMERICAN SECURITY PRODUCTS CO EXPRESSLY PROHIBITED		A
DRAWN R. Tucker	11 FEB 10	SCALE 1/12	DO NOT SCALE DWG	SHEET 1 OF 2

REVISIONS			
REV	DESCRIPTION	DATE	BY
A	REDESIGNED DOORS	14 APR 11	R.F.T.

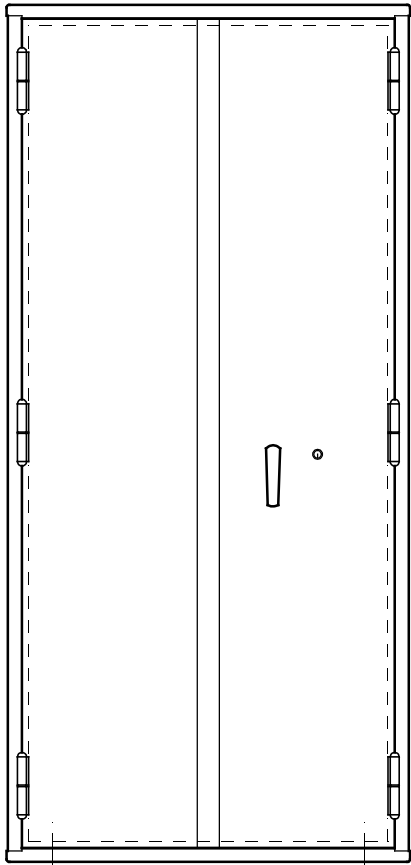

FRONT VIEW

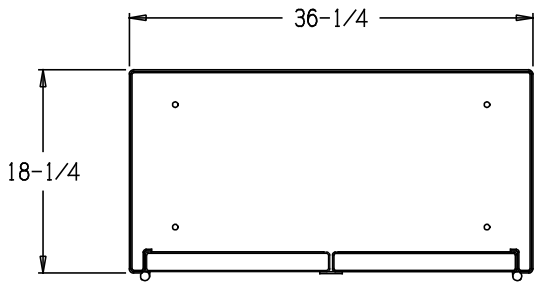

TOP SECTION VIEW

SPECIFICATIONS

1. Safe, 77 H x 36 W x 18 D, Outside, Burglary Class "B".
2. Chest, 76-3/4 H x 35-3/4 W x 17-3/4 (16 Clear) D, Constructed of 1/8" Thick Steel, with a Formed Body. Supplied with Five (5) Adjustable Shelves with Retaining Lip and Molded Protective Edging.
3. Outer Doors, Clear Openings: 73-1/4 H x 32-1/4 W, 1-1/2" Thick, Constructed of Formed 1/8" Thick Steel. Right Door Equipped with UL Listed MEDECO Cam Key Lock, Full Boltwork Cover, "E1" Handle, and Two-Way Locking Mechanism with Two (2) 3/4" Dia. Chrome-Plated Locking Bolts. Left Door Equipped with Full Boltwork Cover.
4. Safe Provided with Four (4) 1/2" Dia. Anchor Holes.
5. Approx. Weight: 517 lbs.

CUSTOMER SIGNATURE		AMSEC AMERICAN SECURITY PRODUCTS COMPANY		
CUSTOMER NAME				
DATE		B Form DD - 77.00 x 36.00 x 18.00 O.D. with MEDECO		
COMPANY NAME				
<small>PROPRIETARY INFORMATION UNAUTHORIZED RELEASE WITHOUT EXPRESS WRITTEN PERMISSION OF AMERICAN SECURITY PRODUCTS CO EXPRESSLY PROHIBITED</small>	ML #	B	Q # 041742-3	SK2010-095
	DRAWN R. Tucker	11 FEB 10	SCALE 1/12	DO NOT SCALE DWG
				SHEET 2 OF 2